



CLEAR21™

Aesthetics PATIENTS WANT,
Results DOCTORS EXPECT

.021 x .021 Square Slot
Early 3D Control, Faster Finishing



PART OF THE
Pitts21
FAMILY



Aesthetics PATIENTS WANT,
Results DOCTORS EXPECT



As the newest addition to the Pitts21 family, the **Clear21** system is designed to deliver consistent results using revolutionary aesthetic self-ligating bracket technology. Add in the patented Pitts “progressive” **square slot technology**, the Clear21 provides early and precise 3D control, giving you the tools you need to finish with the best, and designed to deliver stunning smiles in significantly shorter treatment time.

Bidirectional Hook

Centered bidirectional hook on upper 3's, 4's and 5's are designed for comfort, versatility, and secure retention of auxiliaries.

Designed for Strength & Aesthetics

Injection molded using fine grain alumina ceramic for superior strength, stain resistance, and translucency.

Early Precise 3D Control

In combination with square wire treatment, the precision archwire square slot provides earlier precise 3D control for torque, tip, and rotation. The key to effective 3D control is the precision of the **.021 x .021 slot** and tighter pairing with the archwire. *For example, a typical rectangular system would require the MD width of the door to be approximately 1.7 times wider than Clear21 to maintain equal rotation control.*

Unique Ligation System

The unique ligation system provides reliability and easy operation. Easily opened with a twist using our Quick-Turn Tool* and closed with a gloved finger or the tip of the Quick-Turn Tool. Proprietary processing of the Quick-Turn Tool tip prevents scuff marks on the ceramic surfaces of the bracket to maintain optimal aesthetics.

Designed for Patient Comfort

Injection molded with smooth compound contoured labial-lingual and mesial-distal curvature with rounded corners.

Generous Under Tie-Wing Area

Supports early elastics and power chain.

Clear Lock Base & Simple Debonding

The compound pad contour along with the mechanical interlock base design create optimum pad-to-tooth fit and bond reliability. Designed to easily debond using the OC debonding instrument or similar debonding instruments. Debonding features have been built into the mesial and distal sides of the bracket body to simplify the debonding process.

*Only use the Quick-Turn Tool to operate the ligating door. The use of other instruments might result in damage to the Clear21 bracket.



Powerful Benefits

- **Designed to Reduce Treatment Time**
First and only aesthetic self-ligating system that provides 3D control earlier and throughout treatment.
- **Latest in Technology**
Revolutionary **Pitts .020 x .020 square wire finishing** uses 30-40% lighter forces* with greater control, comfort, and sliding mechanics, with a reliable mechanism.
- **Stunning Smiles**
Progressive slot provides an intelligent balance of control and freedom of movement for effective sliding mechanics and **outstanding finishing**.
- **Control and Finishing**
Predictable finishes in as few as 4 wires.

**Horizontal and vertical forces; compared to rectangular systems*

Color Coded Alignment Guides

Color is applied to the recessed horizontal and long axis alignment guides to improve their visibility during bracket placement. The color in the alignment guides and occlusal distal dot provide bracket identification.



As Few as Four Wires From Start to Finish

With the Clear21 system, you will use as few as four wire change appointments from start to finish. Fewer wires means fewer appointments for your patients, saving you time and money.

Phase	Initial	Working		Finishing	Optional Archwires	
Wire	.014 Thermal Activated Nickel Titanium	.018 x .018 Ultra-Soft Thermal Activated Nickel Titanium	.020 x .020 Thermal Activated Nickel Titanium	.020 x .020 Beta Titanium	.019 x .019 Stainless Steel*	
					Create Arch Width	Close Space
					*Torque bend corrections in the anterior region using stainless steel archwires are not recommended for Clear21.	

We offer a variety of archwires to complement the Clear21 bracket, all built to deliver the torque and control you need with square wire finishing. The Pitts21 Broad "Engage Early" archwire suite have been meticulously designed to achieve 3D control earlier, allowing many Orthodontists to finish cases faster.

Square Wire Finishing

Like Pitts21 metal, Clear21 catches a couple **50% sooner** than a rectangular system, while also **reducing play by 70%**. All with **30-40% lighter forces**, providing you with precise, comfortable 3D control earlier and throughout treatment.

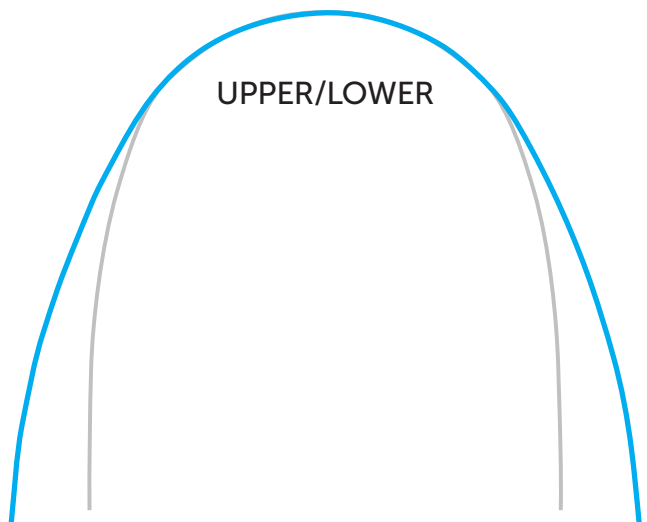

PITTS21/CLEAR21 BROAD ARCHFORM

compared to **NATURAL I ARCHFORM**

Diagrams represent typical arch shapes. Actual sizes may vary slightly.

Torque Control

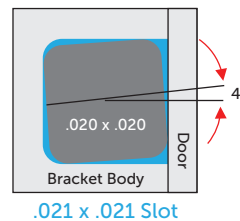

Rotation Control

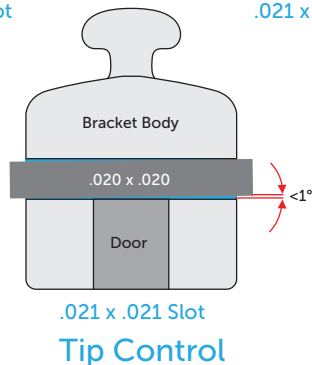
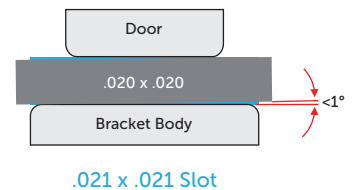

Clear21™ Early Engagement, with Decisive Control

The charts below highlight the impressive impact of the Pitts21 and Clear21 systems. Control can happen earlier in treatment when compared to a rectangular archwire system. Both Pitts21 and Clear21 are designed to work with the “Engage Early” wire progressions of the Pitts21 system which obtains 3D control and catches a couple as soon as 4 weeks into treatment, up to **50% faster than rectangular systems**. Tooth movement is attained using lighter forces than rectangular systems.

Clear21™ Square Wire Treatment vs. Rectangular Wire Treatment

Clear21 Square Wire Treatment - .021 x .021 SLOT							
Phase	Initial		Working			Finishing	
Wire	.014 Thermal Activated Nickel Titanium		.018 x .018 Ultra-Soft Thermal Activated Nickel Titanium		.020 x .020 Thermal Activated Nickel Titanium		.020 x .020 Beta Titanium
Torque	No Control		14.2°	51% More Control	4.2°	70% More Control	4.2° 62% More Control
Rotation	4.5°	47% More Control	1.9°	Same	0.6°	65% More Control	0.6° 65% More Control
Tip	3.8°	11% More Control	1.9°	55% More Control	0.6°	74% More Control	0.6° 66% More Control

Compared To	Rectangular Archwire Treatment - .022 x .028 SLOT						
Phase	Initial		Working		Finishing		
Wire	.014 Nickel Titanium	.018 Nickel Titanium	.014 x .025 Nickel Titanium		.018 x .025 Nickel Titanium		.019 x .025 Stainless Steel
Torque	No Control	No Control	28.8°		13.8°		10.9°
Rotation	8.5°	6.1°	1.9°		1.9°		1.9°
Tip	4.3°	2.2°	4.3°		2.2°		1.6°

Charts based on anterior teeth (cuspid to cuspid) with minimal A/P discrepancy

Clear21™ Catches a Couple Sooner!

Clear21™ Early Torque Control, Faster Finishing

With Pitts21 and Clear21, torque control is started by the 2nd wire (4 to 6 weeks from the start of treatment). In a rectangular system, there is no effective torque control until the fourth wire (.018 x .025); **which can be up to 30 weeks from the start of treatment!** The amount and timing of moments capable of torsional correction make Pitts 21 and Clear21 the most efficient brackets available.

Available Torsion - at 10° Clear21™ Square Slot vs a Rectangular Slot

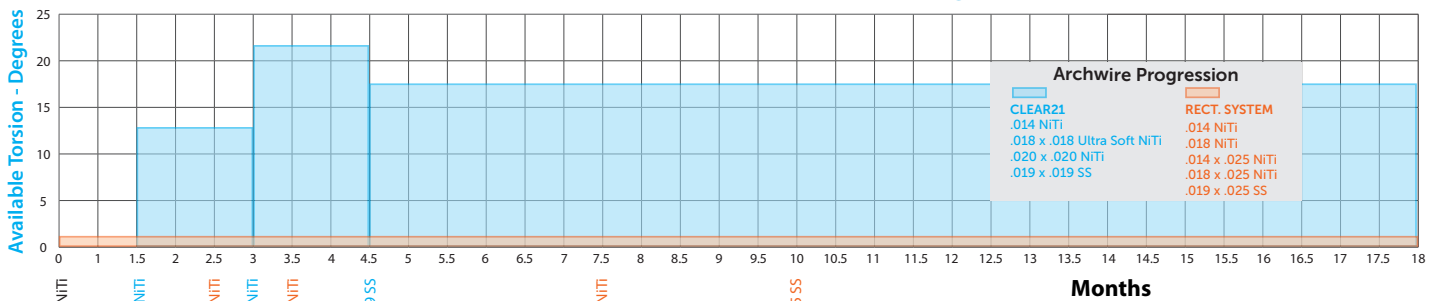

Available Torsion - at 28° Clear21™ Square Slot vs a Rectangular Slot

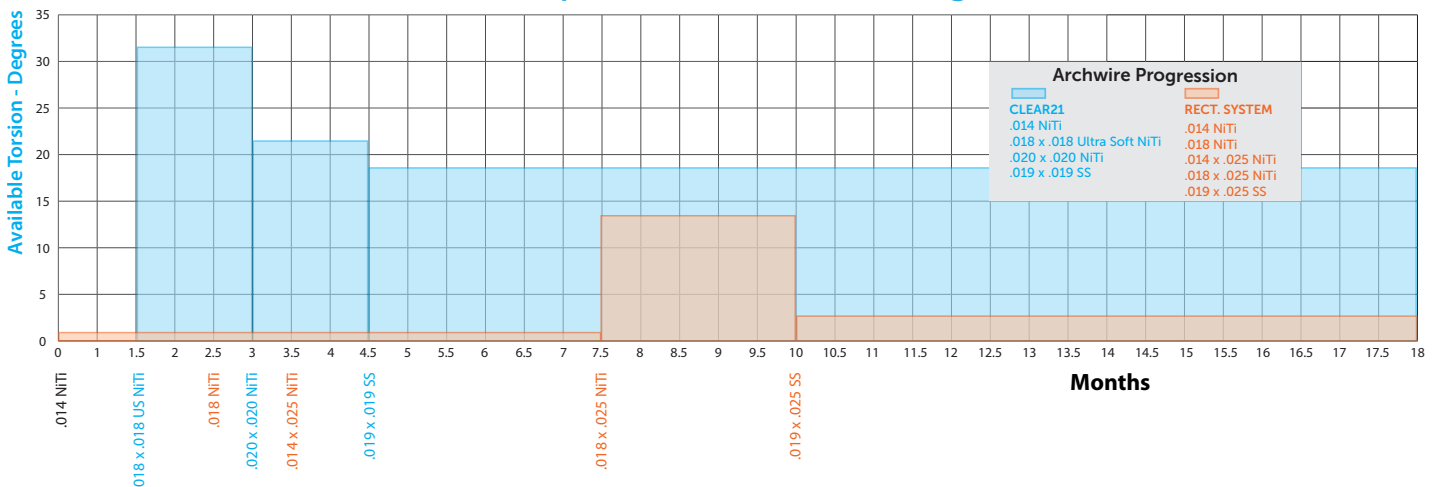

- The charts presents the time phased **Available Torsion** without the use of wire bends or auxiliary devices for 10 degrees (upper chart) and 28 degrees (lower chart) of initial tooth torque discrepancy
- Without wire bends or auxiliary devices there is no **Available Torsion** for 10 degrees and limited available torsion at 28 degrees of torque discrepancy with a rectangular bracket & archwire system due the inherent system play

Clear21™ Prescription

Unlike other aesthetic bracket systems, the versatile Clear21 system is a single prescription for all patients. Without the need for a variable bracket inventory, you can simplify processes for your staff while reducing your bracket inventory, saving you both time and money.

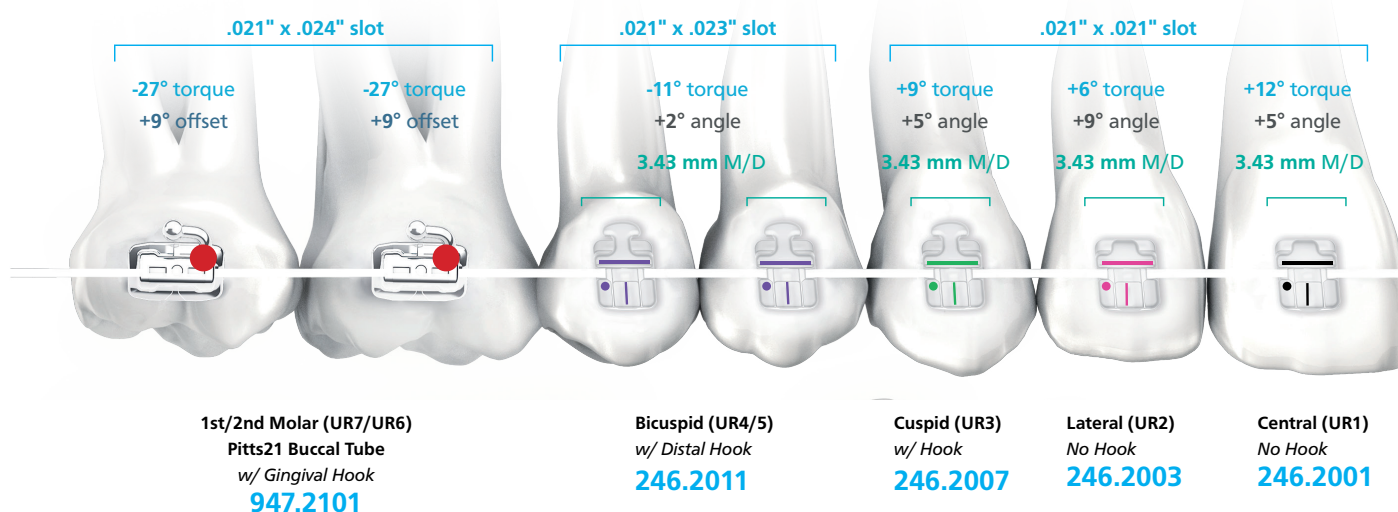

Right

Right

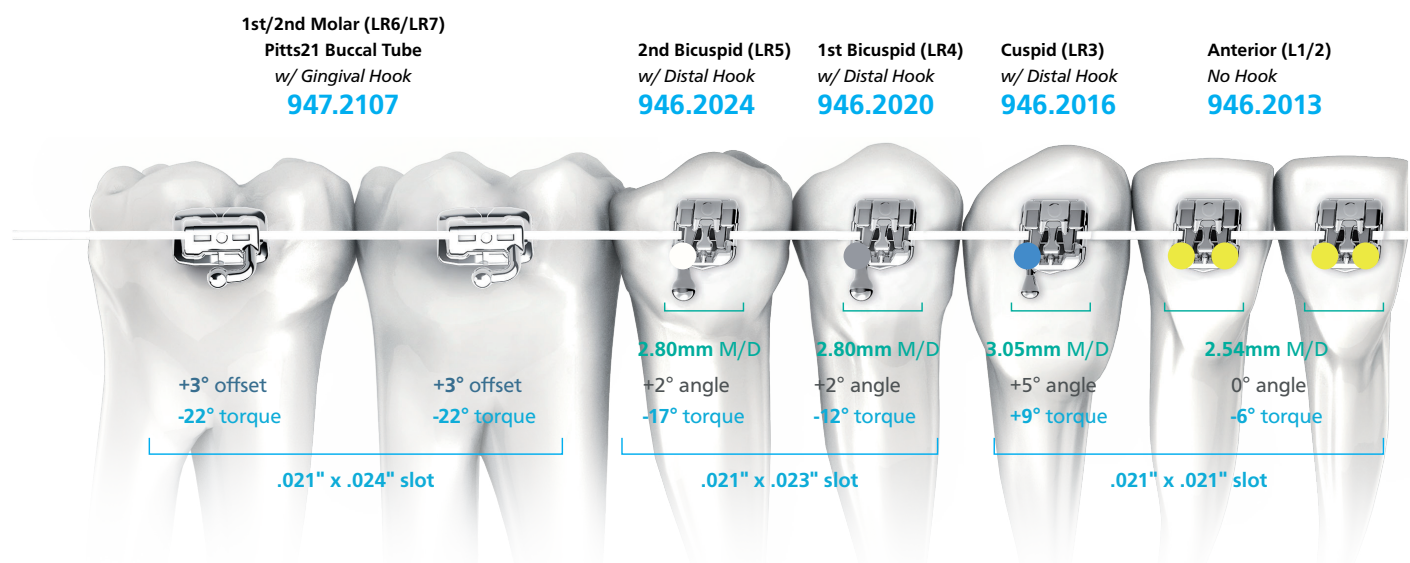

Clear21™ / Pitts21® Full Sets

5x5 Case
 (20 Brackets, **C21 U 3x3**)
 Hooks on 3's, 4's, & 5's
#246.2033

5x5 Case
 (20 Brackets, **C21 U 5x5**)
 Hooks on 3's, 4's, & 5's
#246.2032

7x7 Case (-27 U6's)
 (20 Brackets / 8 Tubes, **C21 U 3x3**)
 Hooks on 3's, 4's, & 5's
#246.2156

7x7 Case (-27 U6's)
 (20 Brackets / 8 Tubes, **C21 U 5x5**)
 Hooks on 3's, 4's, & 5's
#246.2155

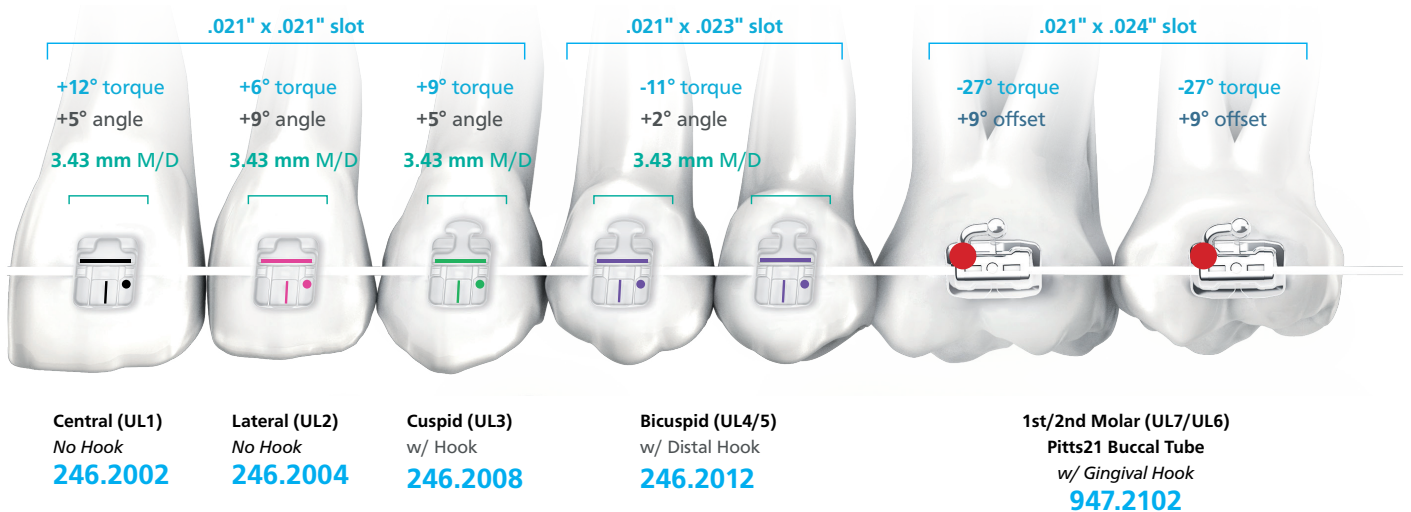

Left

Left

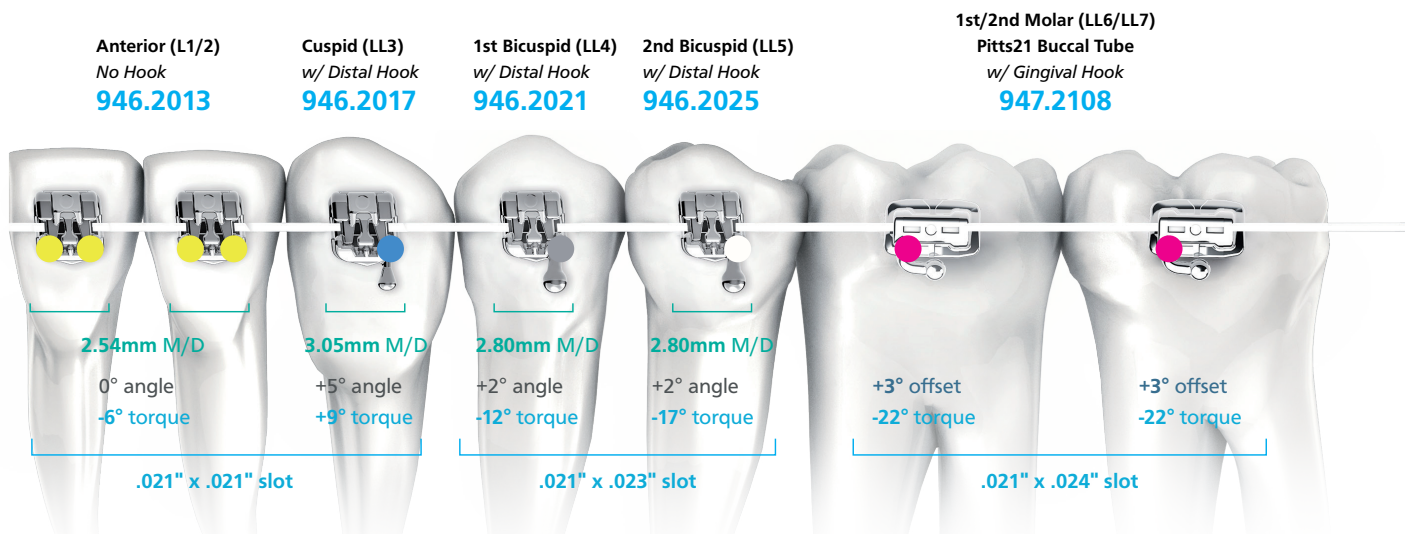

QUICK-TURN™ #246.1000

The specially designed **Quick-Turn** tool is a key component of the Clear21 System and is required to operate the ligating door. It provides smooth insertion and rotation for quick opening of bracket doors.



Fast, comfortable wire changes
are a **QUICK-TURN** away

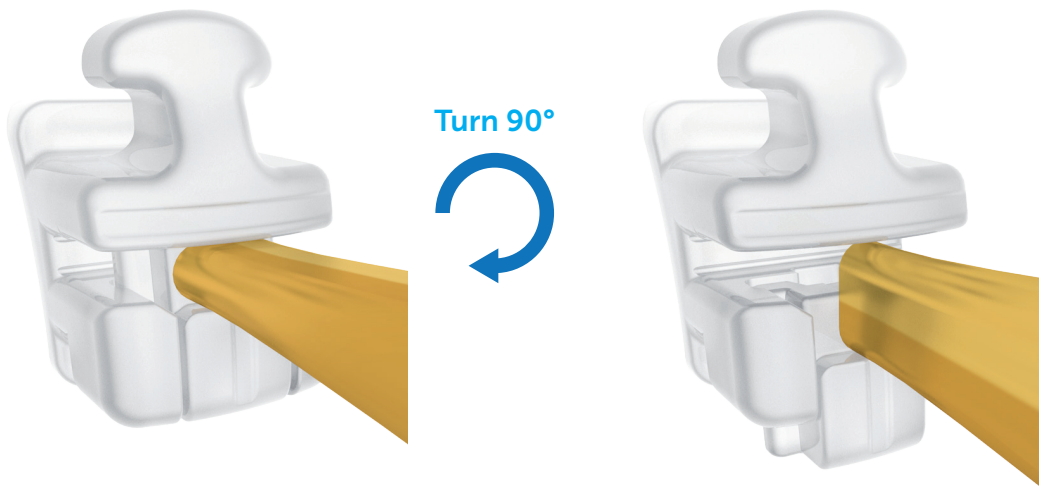
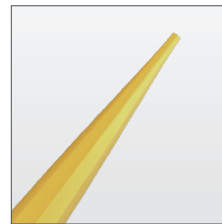

Orthodontic Debonding Instrument #533-0400

Quality construction and design allows for easy removal of bonded brackets without patient discomfort. Precision diamond honed edges work on all types of brackets including Clear21. Tip width is 4.6mm.

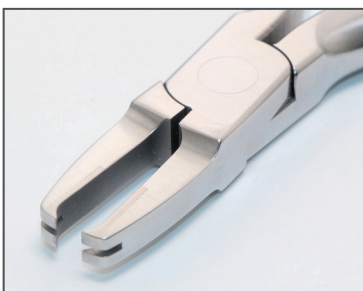

Archwire Seating Instrument

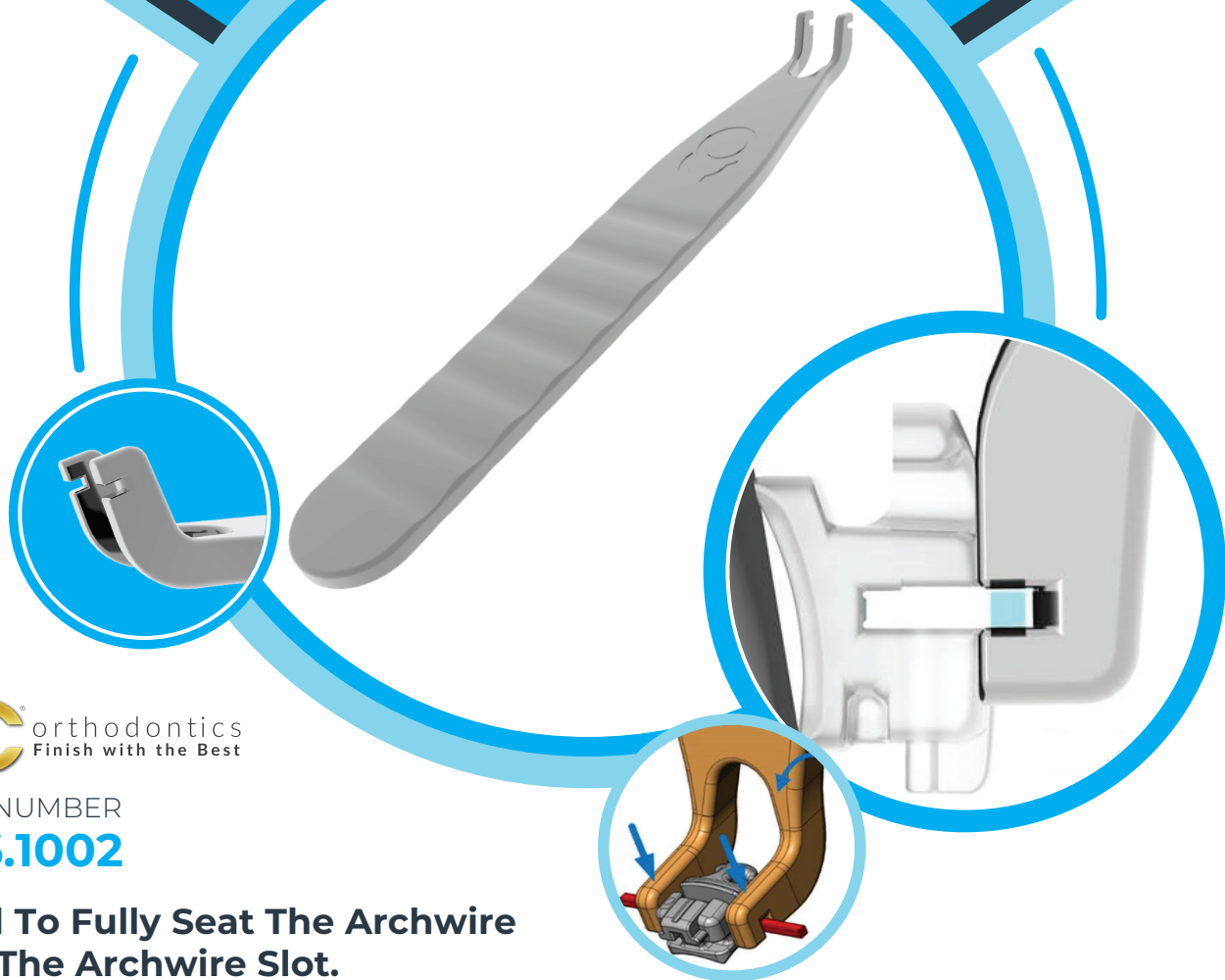

PART NUMBER
246.1002

Used To Fully Seat The Archwire Into The Archwire Slot.

The Archwire Seating Instrument is the perfect tool for fully seating and de-torque larger cross-section archwires like .019" x .019" and .020" x .020". The tool also simplifies the installation of archwires with smaller cross-sections and more resilient materials like Nickel-Titanium. The ligating door on the Pitts21 or Clear21 brackets are easily closed once the archwire is fully seated into the archwire slot.

Features & Benefits

- Fully seats and de-torques larger cross-section archwires
- Simplifies installation stiffer archwire materials
- Helps for easier ligating door closure



Model: Hoang Thuc Diem, Photo courtesy of Dr. Hai Anh Vu

CREATING PATIENTS WITH CONFIDENT SMILES

