



orthodontics

*Pitts*21[®] PRO

TREATMENT REDEFINED



EXPERIENCE

PROGRESS

Pitts21[®] PRO

QUICK-TURN™

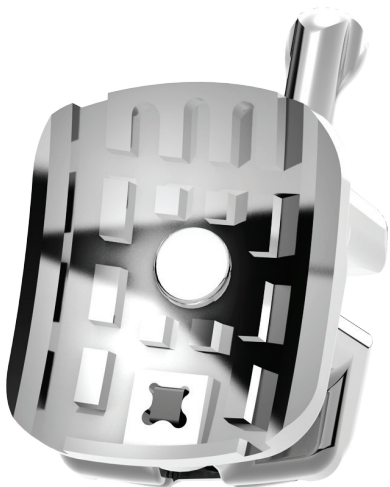

ENHANCED USER EXPERIENCE

The Pitts21® PRO Self-Ligating Bracket System delivers consistent results using the most innovative self-ligating bracket technology. With unrivaled early 3D control of torque, tip and rotation, Pitts21® PRO reduces treatment time helping you deliver beautiful finishes faster.

Quick-Turn Easy Opening Door Design

The unique ligation system provides reliability and easy operation. Easily opened with a twist using our Quick-Turn Tool and closed with a gloved finger.

Patented Square Wire & Progressive Slot System

Provides a tighter pairing of the wire and the slot in the anterior brackets while enhancing sliding of the wire through the posterior brackets; leading to earlier engagement, reduced appointments and beautiful finishes faster.

Permanent Bracket Identification

Permanent identification for easy bracket to tooth identification.

Smooth, Rounded Edges

Ensures that your patients have the most comfortable experience.

Base Lock Plus

One piece base/bracket aims to create an optimum pad-to-tooth fit and bond strength resulting in fewer broken brackets and fewer debonding issues.

Integrated Hooks

An available option on the 3's, 4's and 5's for your convenience at no extra charge.

Square Wire Finishing

Provides you with unparalleled 3D control earlier and throughout treatment.

EXPERIENCE PROGRESSIVE

EARLY ENGAGEMENT, CONTROL, AND EFFICIENCY



Early Engagement

The Pitts21® PRO proprietary progressive slot system, square in anterior and rectangular in posterior, combined with the innovative Pitts archwire suite allows the practitioner to fill the slot earlier in treatment without the excessive forces that would plague traditional rectangular self-ligating systems.

Progressive Slot

The Pitts21® PRO's progressive slot provides exceptional 3D control of the anterior teeth and 3rd order control of the posterior teeth, while allowing the archwire to slide easily through the posterior brackets.

PITTS21® PRO DELIVERS EXCEPTIONAL ANTERIOR 3D CONTROL AND POSTERIOR 3RD ORDER CONTROL THROUGHOUT TREATMENT



KEY SYSTEM FEATURES

- Early Initial Engagement
- Early Full Engagement
- Engagement with patient friendly, light biologically active forces.
- Uncomplicated single prescription system and dynamic archwire suite allows for simultaneous early expansion and early engagement

EXPERIENCE **PRODUCTIVITY**

The Pitts21® PRO, in combination with the **Engage Early** and **Expand Early** archwire suite, provide immediate expansion and simultaneous 1st, 2nd, and 3rd order control from very early in the treatment cycle. All Pitts21® System Archforms fully leverage the concept of “Variable Modulus Orthodontics”, allowing variation (modulation) in the delivered force levels WITHOUT varying the archwire profile. Utilizing this “game changing” technology will forever change the way you practice, and dramatically improve your patient’s experience.

Available in a variety of archforms including “Broad”, “Broad+”, and “Broad ++”. These archwires are designed to work with Pitts21®, Pitts21® PRO, and Clear21 bracket systems.

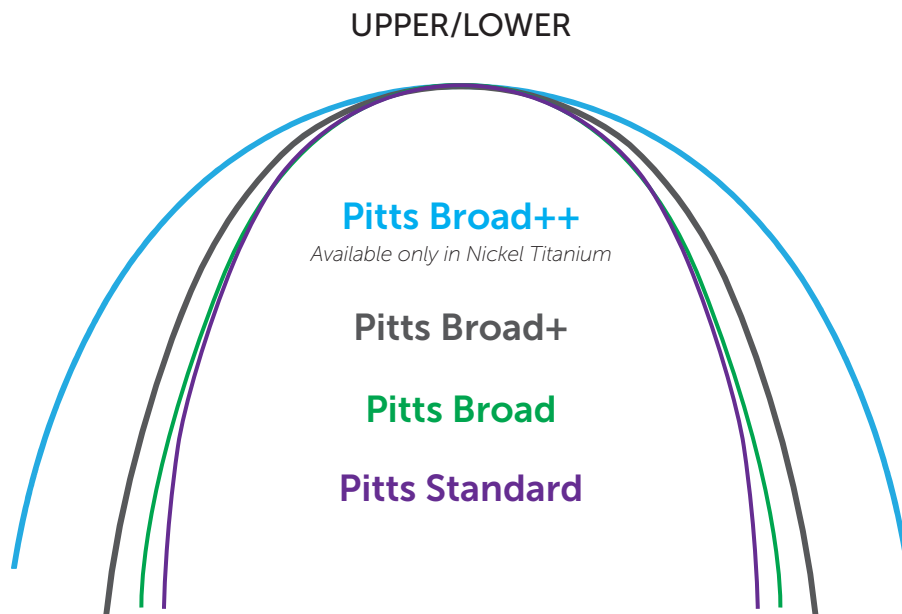

Diagrams represent typical arch shapes. Actual sizes may vary slightly.

PITTS “ENGAGE EARLY” AND “EXPAND EARLY” ARCHWIRE SUITE

Phase	Initial	Working	Finishing
Wire	.014 Thermal Activated Nickel Titanium	.018 x .018 Ultra-Soft Thermal Activated Nickel Titanium	.020 x .020 (Upper) Thermal Activated Nickel Titanium .019 x .019 (Lower) Thermal Activated Nickel Titanium *.020 x .020 <i>Beta Titanium can be use on upper</i>

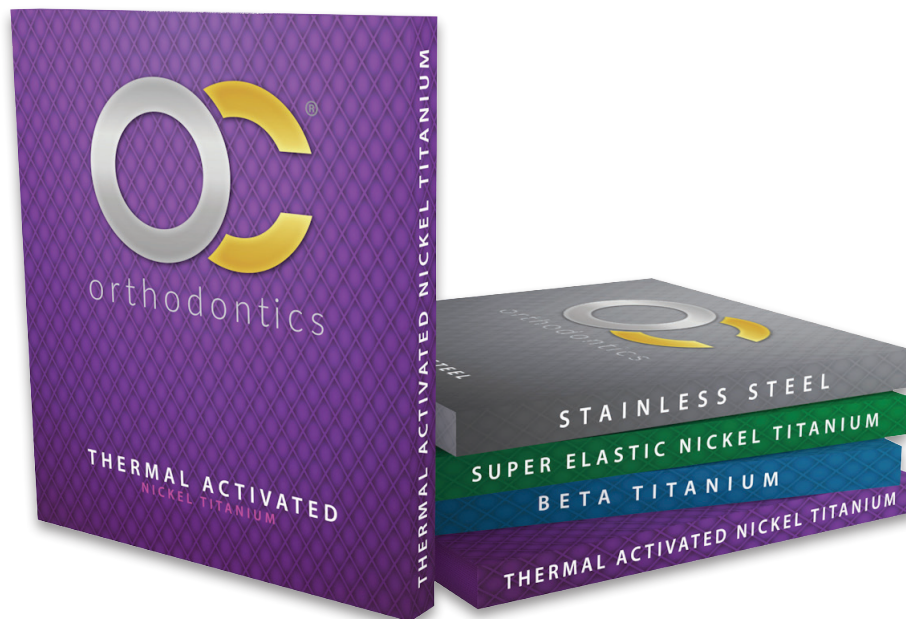

MOST PRACTITIONERS SAVE AN AVERAGE OF 3 TO 4 APPOINTMENTS

EXPERIENCE

PROFITABILITY

Unlike other bracket systems, the versatile Pitts21® PRO System is a single prescription for all patients. Without the need for a variable bracket inventory, you can simplify processes for your staff while reducing your bracket inventory, saving you both time and money.

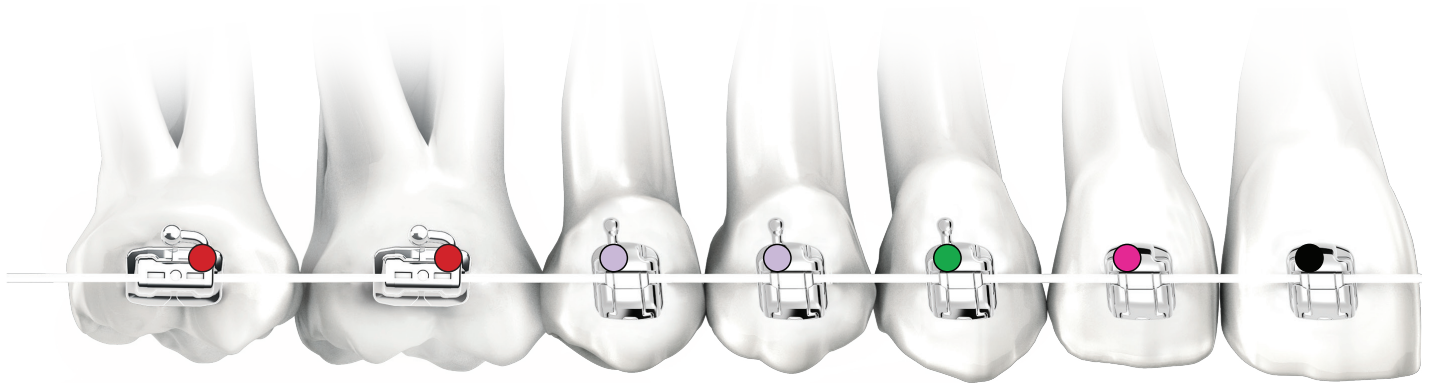

1st/2nd Molar (UR7/UR6)
P21 Buccal Tube
w/ Gingival Hook
947.2101

Bicuspid (UR4/5)
w/ Distal Hook
956.2011

Cuspid (UR3)
w/ Distal Hook
956.2007

Lateral (UR2)
No Hook
956.2003

Central (UR1)
No Hook
956.2001

Right

Right

2nd Molar (LR7)
P21 Buccal Tube
w/ Gingival Hook
947.2107

1st Molar (LR6)
P21 Buccal Tube
w/ Gingival Hook
947.2107

2nd Bicuspid (LR5)
w/ Distal Hook
956.2024

1st Bicuspid (LR4)
w/ Distal Hook
956.2020

Cuspid (LR3)
w/ Distal Hook
956.2016

Anterior (L1/2)
No Hook
956.2013



Single Prescription Inventory

5x5 Case (20 Brackets)

Hooks on 3's, 4's, & 5's
#956.2032

7x7 Case (-27 U6's)

(20 Brackets & 8 Buccal Tubes)
Hooks on 3's, 4's, & 5's
#956.2155

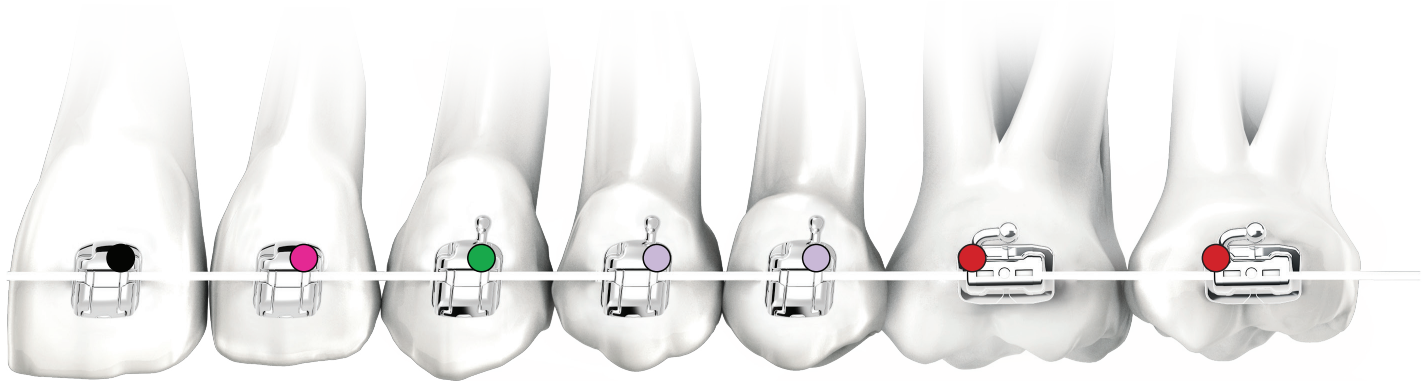

Central (UL1)
No Hook
956.2002

Lateral (UL2)
No Hook
956.2004

Cuspid (UL3)
w/ Distal Hook
956.2008

Bicuspid (UL4/5)
w/ Distal Hook
956.2012

1st/2nd Molar (UL7/UL6)
P21 Buccal Tube
w/ Gingival Hook
947.2102

Left

Left

Anterior (L1/2)
No Hook
956.2013

Cuspid (LL3)
w/ Distal Hook
956.2017

1st Bicuspid (LL4)
w/ Distal Hook
956.2021

2nd Bicuspid (LL5)
w/ Distal Hook
956.2025

1st Molar (LL6)
P21 Buccal Tube
w/ Gingival Hook
947.2108

2nd Molar (LL7)
P21 Buccal Tube
w/ Gingival Hook
947.2108

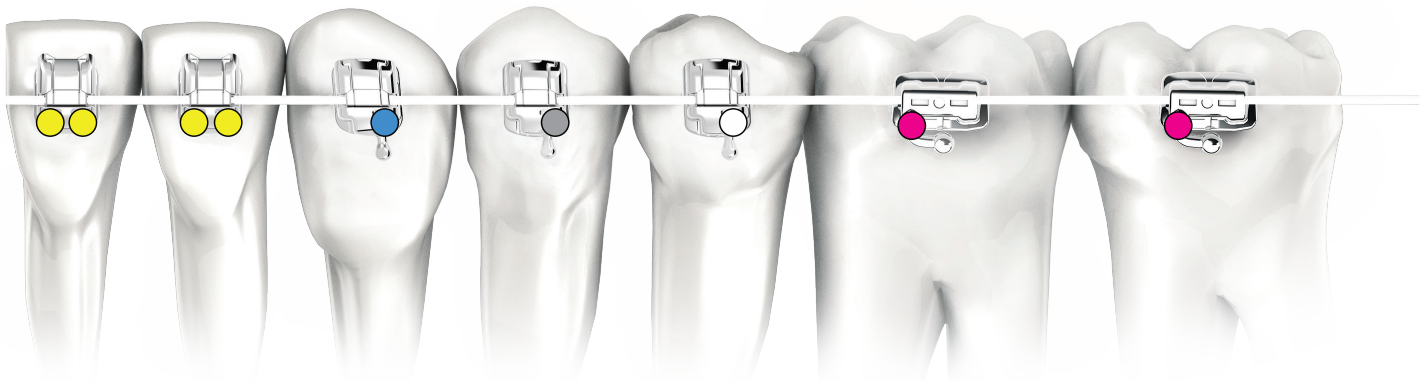

QUICK-TURN™ #246.1000

The specially designed **Quick-Turn** tool is a key component to both the Pitts21® PRO and Clear21 System and is required to operate the ligating door. It provides smooth insertion and rotation for quick opening of bracket doors.



Fast, comfortable wire changes
are a **QUICK-TURN** away

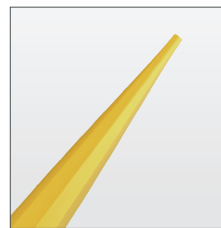

Turn 90°

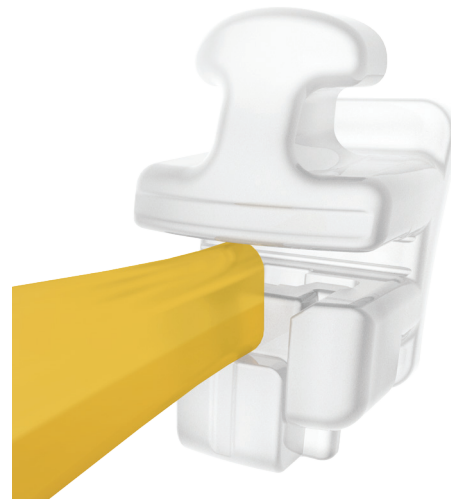

CLEAR21™ & Pitts21® PRO

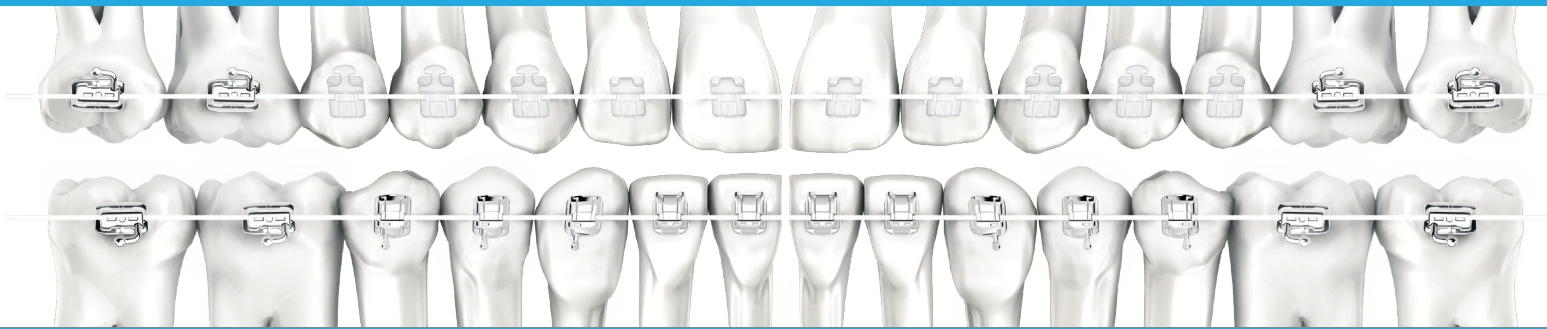

PROUD

Are you ready to be **PROUD** of your finishes?

The Pitts21® PRO Self-Ligating Bracket System is the next revolution in self-ligating systems. Designed to make your practice more profitable, productive, and progressive. The Pitts21® PRO's proprietary square wire and progressive slot system obtains engagement earlier while producing gentle forces that are biologically active. Match it with the Clear21 for a complete functional and aesthetic system.

Pitts21[®] PRO

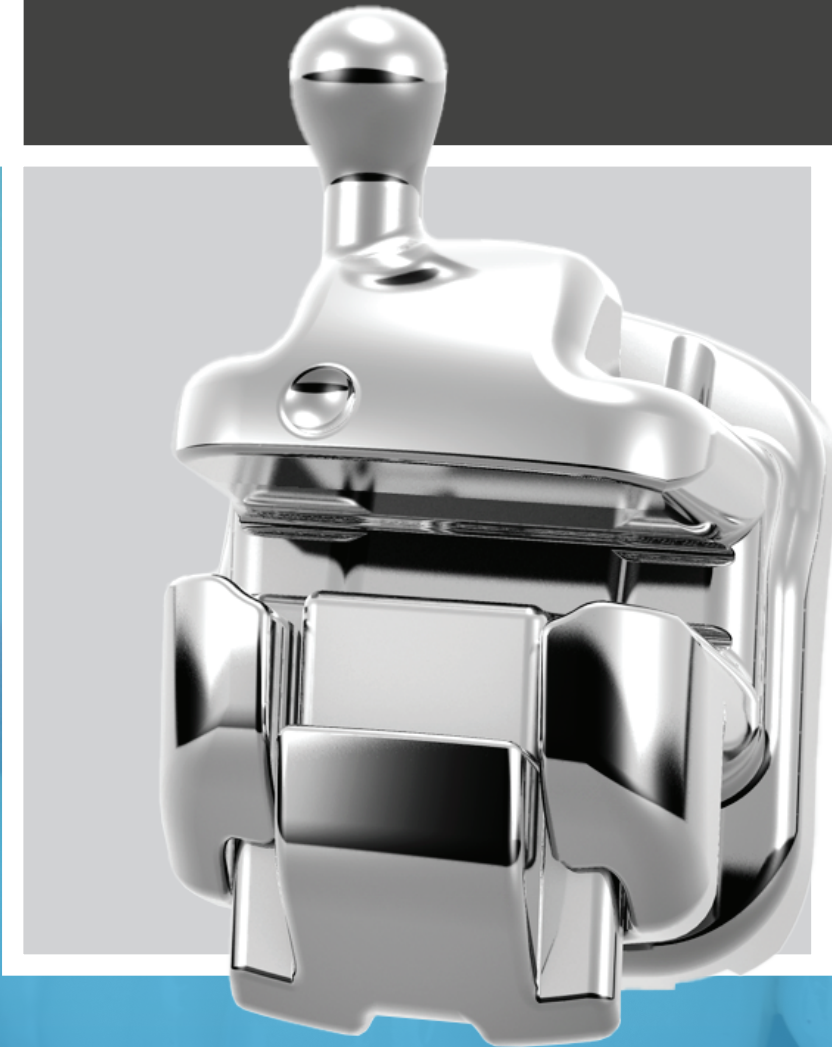

TREATMENT REDEFINED

(866) 752-0065 | www.oc-orthodontics.com



OC Orthodontics
1300 NE Alpha Dr.
McMinnville, OR 97128 USA

Rev. A
PN: MAR.049
US Patent No. 11,160,638
©2022 All Rights Reserved OC Orthodontics